

# WEDA PUMP

World leader in professional submersible drainage pumps

## SPAREPARTS CATALOGUE

# RL 6090



## **SPARE PARTS CATALOGUE**

### **RESERVDDELSTÄLLNING**

Följande uppgifter ska lämnas vid beställning av reservdelar för att undvika leveransfel :

1. Maskintyp.
2. Vältens serienummer.
3. Antal av önskad reservdel.
4. Reserdelens artikelnummer.
5. Reservedelens benämning.
6. Måttuppgifter vid beställning av metervara.

### **ERSATZTEILBESTELLUNG**

Zur Vermeidung von Fehllieferungen sind bei der Bestellung von Ersatzteilen folgende Angaben zu machen :

1. Mashinentyp.
2. Herstellungsnummer.
3. Bestellmenge. (Quantity)
4. Ersatzteilbenennung. (Part N°)
5. Ersatzteilbenennung. (Description)
6. Massangaben bei Bestellung von Meterware.

### **PEDIDO DE RECAMBIOS**

Para evitar errores en las entregas, deberá indicarse los siguientes datos al hacer un pedido de recambios :

1. Tipo de máquina.
2. Número de serie.
3. Cantidad de piezas deseadas. (Quantity)
4. Número de artículo de la pieza de recambio. (Part N°)
5. Denominación de la pieza. (Description)
6. Indíquese la medida al solicitar un artículo que se expide por metros.

### **RESERVEDELEN BESTELLEN**

Om foutieve leveringen te voorkomen, vermeld bij uw bestelling de volgende informatie:

1. Type van de machine (pomp)
2. Machine serienummer
3. Aantal benodigd
4. Onderdeel nummer(s)
5. Onderdeel omschrijving
6. Afmetingen indien per lengte besteld wordt.

### **ORDERING SPARE PARTS**

To avoid errors in delivery, please give the following information when ordering spare parts :

1. Type of machine.
2. Machine serial number.
3. Quantity required.
4. Part number.
5. Parts description.
6. Dimensions when ordering per length.

### **ORDINI DI RICAMBI**

Per evitare errori nelle consegne di ricambi, Vi preghiamo di comunicarci le seguenti informazioni al momento dell'ordinazione :

1. Tipo di macchina.
2. Numero di serie della macchina.
3. Quantità dei pezzi desiderati. (Quantity)
4. Numero di codice del pezzo. (Part N°)
5. Descrizione del pezzo di ricambio. (Description)
6. Misura, in caso di ordine per metro.

### **COMMANDE DE PIÈCES DE RECHANGE**

Les indications suivantes doivent être fournies lors de la commande de pièces de rechange, afin d'éviter toute erreur de livraison :

1. Type de machine.
2. Numéro de série.
3. Quantité désirée de pièce de rechange. (Quantity)
4. Numéro de la pièce de rechange. (Part N°)
5. Description de la pièce de rechange. (Description)
6. Longueur en cas de commande par mètre.

## SPARE PARTS

Note : To place spare parts order, use :

- The serial number of the machine
- The description and part number;

RL6090									
Ref	Designation	P/N	Qty		Ref	Designation	P/N	Qty	
			LH	HH				LH	HH
1	Handle complete	W292062	1	1	60	Stop washer	W294038	1	1
2	Rivet	W65430	4	4	61	Nut	W294037	1	1
3	Data plate	W743583	1	1	62	Bearing bracket	W291021	1	1
4	Sealing	W209428	1	1	63	O-ring	W65031	1	1
5	Washer	W209731	1	1	64	Circlip	W50679	3	3
6	Sealing	W209429	1	1	65	Seal holder	W294109	1	1
7	Piston direct start	W209647	1	1	66	Upper seal	W294107	1	1
	Piston Y/D start	W274084	1	1	67	Holder *	W294106	1	1
8	Spring	W209434	1	1		Holder **	W743506	1	1
9	Guide	W209435	1	1	68	O-ring	W294105	2	2
10	Nut	W84211	6	6	69	Distance ring *	W294112	1	1
11	Cover 380-500V	W292064	1	1		Distance ring **	W743531	1	1
	Cover for NVB	W292213	1	1	70	O-ring	W65112	2	2
12	Nut	W84210	7	7	71	Bearing	W294111	2	2
13	Washer	W209438	1	1		Bearing cpl Incl pos 69,71	W294110	1	1
14	Screw	W209501	1	1	72	Bearing bracket	W292055	1	1
15	O-ring	W65134	3	3	73	Washer	W294171	7	7
16	O-ring	W65251	1	1	74	Lower seal	W294108	1	1
17	Plug	W294127	2	2	75	Oil bag Incl. pos 76	W293088	1	1
18	Sleeve 380-500V	W294164	2	2	76	Seal clamp	W294226	1	1
	Sleeve 220V Y/D	W294125	2	2	77	Ring for oil bag	W294103	1	1
19	Screw	W78698	1	1	79	Impeller 50Hz	W292043	1	-
20	Thrust collar	W294126	2	2		Impeller 60Hz	W292044	1	-
21	Nut	W84213	2	2	80	Washer	W294036	1	1
22	Stud bolt	W69656	6	2	81	Impeller nut	W294035	1	1
23	Top bracket 380-415V Y/D direct start	W291020	1	1	82	Protective housing	W292065	1	1
	Top bracket 380-415VY/D start	W292204	1	1	83	Diffusor	W291012	1	-
	Top bracket 230V for external protection	W292312	1	1	84	O-ring	W65174	1	1
	Top bracket 230V	W293097	1	1	85	O-ring	W65137	1	1
	Top bracket 380-415V external Y/D start without thermal protection	W730011	1	1	86	Diffusor holder	W293080	1	1
24	O-ring	W65033	1	1	87	Washer	W51181	6	6
25	O-ring	W65177	2	2	89	Washer	W51176	8	8
26	Stud bolt	W294123	2	2		Trim washer	W294124	20	20
27	O-ring	W65143	1	1	90	Diffusor centre	W291014	1	-
28	Inner casing	W291025	1	1	91	Spring washer	W58915	10	10
29	Stud bolt	W293087	4	4	92	Strainer	W294102	1	1
30	Stator See page 12	-	-	-	93	Base plate	W293091	1	1
31	Discharge 4" for hose	W203564	1	1	94	Screw	W76343	6	6
	Discharge 4" BSP thread	W203482	1	1	95	Impeller 50 Hz	W292045	-	1
	Discharge 4" NPT thread	W203572	1	1		Impeller 60Hz	W292046	-	1
32	Washer	W51170	6	6	96	Diffusor	W291016	-	1
33	Stud bolt	W69640	6	6	97	Spacer	W294191	-	4
34	O-ring	W743466	1	1	98	Stud bolt	W69656	-	4
35	Jointing bracket Incl pos 12,32,33,36.	W282059	1	1	99	Diffusor centre	W291018	-	1

RL6090 (continued)

Ref	Designation	P/N	Qty		Ref	Designation	P/N	Qty	
			LH	HH				LH	HH
36	Discharge packing	W284058	1	1	100	Electrode	W208106	1	-
37	Discharge 6" for hose	W283166	1	1	101	Washer	W209673	2	-
	Discharge 6" BSP thread	W283176	1	1	102	Nut	W84205	4	-
	Discharge 6" NPT thread	W283168	1	1	103	Flat pin	W50331	2	-
38	Cable inlet cpl .4x10mm <sup>2</sup> 415-550V Y/D start incl. pos 44,49 .	W284103	1	1	104	Bracket	W209672	1	-
	Cable inlet cpl .4x16mm <sup>2</sup> 400V incl. pos 44,49 .	W284104	1	1	105	Wiring diagram	W209865	1	-
	Cable inlet cpl .4x25mm <sup>2</sup> 230V incl. pos 44,49 .	W209580	1	1	106	Short circuit	W209674	1	-
39	Cable 4x10mm <sup>2</sup> 415-550V direct start	W283105	1	1	107	Electronic unit NVB 400V 50Hz	W209805	1	-
	Cable 4x10mm <sup>2</sup> 400V Y/Dstart 415V Y/D start	W283105	2	2		Electronic unit NVB 440V 60Hz	W367186	1	-
	Cable 4x16mm <sup>2</sup> 400V direct start	W284108	1	1		Electronic unit NVB 220V 50Hz	W367192	1	-
	Cable 4x16mm <sup>2</sup> 400V Y/D start	W284108	1	1		Electronic unit NVB 240V 60Hz	W367193	1	-
	Cable 4x25mm <sup>2</sup> 230V+230/400V	W208093	1	1		Electronic unit NVB 500V 50Hz	W209930	1	1
40	Circlip	W50525	1	1	108	Time relay 220-500V	W743509	1	1
41	Bearing	W61003	1	1	109	Terminal block 25mm <sup>2</sup>	W209874	1	1
42	Cable sleeve 4x10mm <sup>2</sup>	W284110	1	1	110	Time relay Y9a 400V	W209783	1	1
	Cable sleeve 4x16mm <sup>2</sup>	W284100	1	1	111	Y/D Start cpl 400V	W292069	1	1
	Cable sleeve 4x25mm <sup>2</sup>	W743583	1	1	113	Over current relay	W299593	1	1
43	Rotor	W292053	1	1	114	Bracket	W292061	1	1
50	O-ring	W65140	1	1	115	Contactora See page 12	-	-	-
51	O-ring	W65006	2	2	116	Coil See page 12	-	-	-
52	Seal unit cpl	W292054	1	1	117	Over current relay 220/440V60Hz	W294155	1	1
53	Oil plug	W274084	2	2		Over current relay 500V 50Hz	W743517	1	1
54	Screw	W75711	11	11		Over current relay 230/400V 50Hz 440/500V60Hz	W743549	1	1
55	Wear plate	W291010	1	1	118	Short circuit	W209928	1	1
56	Nut	W84213	8	8	119	Bracket	W214871	1	1
57	Distance sleeve	W294041	1	1	120	Wiring diagram	W740049	1	1
58	Connection	W294039	1	1		Wiring diagram	W740276	1	1
59	Trim washer	W294040	10	10		Wiring diagram	W740277	1	1
					122	Oil 5,2 l	W60015	1	1

\* Pumps with manufacturing N° below 1971 . \*\* Pumps with manufacturing N° above 2000 .

### STATOR and CONTACTOR Part Numbers

Power supply	Stator	Contactora complete	Coil for contactora	Stator Unit (28 + 30)
380-400V - 3 - 50Hz	W294139	W208125	W209771	W294149
415V - 3 - 50Hz	W294140	W208126	W209772	W294169
440V - 3 - 60Hz	W294139	W208125	W209771	W294149
500V - 3 - 50Hz	W294154	W208127	W209773	W294170

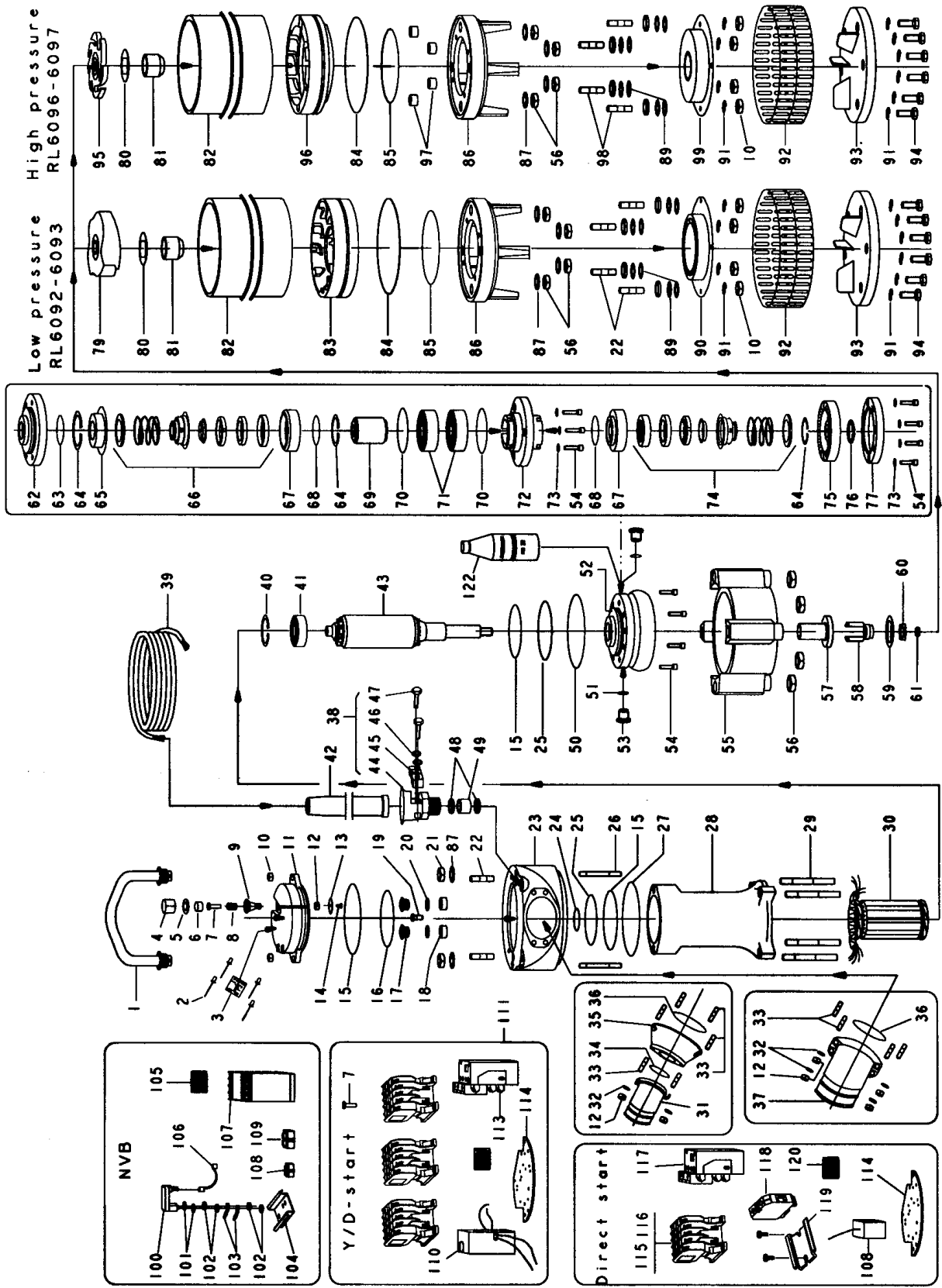

# WEDA PUMP

World leader in professional submersible drainage pumps

*page left intentionally blank for your convenience.*

# WEDA PUMP

World leader in professional submersible drainage pumps

## **Delta Pompen B.V.**

P.O. Box 310  
7570 AH Oldenzaal  
The Netherlands

Tel. : +31 (0)541 571667

Fax.: +31 (0)84 2242375

E-mail: [info@wedapump.com](mailto:info@wedapump.com)

Internet: <http://www.wedapump.com>

Lübeckstraat 12  
7575 EE Oldenzaal

### SERVICE AND GUARANTEE.

WEDAPUMP.COM is represented worldwide by a well-established service organization. Contact your local WEDAPUMP sales office if you require more information about servicing. Or left mentioned address.

wedapump.com reserves the right to change specifications without notice