

WEDA PUMP

World leader in professional submersible drainage pumps

SPAREPARTS CATALOGUE

RL 6070



SPARE PARTS CATALOGUE

RESERVDLSTÄLLNING

Följande uppgifter ska lämnas vid beställning av reservdelar för att undvika leveransfel :

1. Maskintyp.
2. Vältens serinumner.
3. Antal av önskad reservdel.
4. Reserdelens artikelnummer.
5. Reservedelens benämning.
6. Måttuppgifter vid beställning av metervara.

ERSATZTEILBESTELLUNG

Zur Vermeidung von Fehllieferungen sind bei der Bestellung von Ersatzteilen folgende Angaben zu machen :

1. Mashinentyp.
2. Herstellungsnummer.
3. Bestellmenge. (Quantity)
4. Ersatzteilbenennung. (Part N°)
5. Ersatzteilbenennung. (Description)
6. Massangaben bei Bestellung von Meterware.

PEDIDO DE RECAMBIOS

Para evitar errores en las entregas, deberá indicarse los siguientes datos al hacer un pedido de recambios :

1. Tipo de máquina.
2. Número de serie.
3. Cantidad de piezas deseadas. (Quantity)
4. Número de artículo de la pieza de recambio. (Part N°)
5. Denominación de la pieza. (Description)
6. Indíquese la medida al solicitar un artículo que se expide por metros.

RESERVEDELEN BESTELLEN

Om foutieve leveringen te voorkomen, vermeld bij uw bestelling de volgende informatie:

1. Type van de machine (pomp)
2. Machine serienummer
3. Aantal benodigd
4. Onderdeel nummer(s)
5. Onderdeel omschrijving
6. Afmetingen indien per lengte besteld wordt.

ORDERING SPARE PARTS

To avoid errors in delivery, please give the following information when ordering spare parts :

1. Type of machine.
2. Machine serial number.
3. Quantity required.
4. Part number.
5. Parts description.
6. Dimensions when ordering per length.

ORDINI DI RICAMBI

Per evitare errori nelle consegne di ricambi, Vi preghiamo di comunicarci le seguenti informazioni al momento dell'ordinazione :

1. Tipo di macchina.
2. Numero di serie della macchina.
3. Quantità dei pezzi desiderati. (Quantity)
4. Numero di codice del pezzo. (Part N°)
5. Descrizione del pezzo di ricambio. (Description)
6. Misura, in caso di ordine per metro.

COMMANDE DE PIÈCES DE RECHANGE

Les indications suivantes doivent être fournies lors de la commande de pièces de rechange, afin d'éviter toute erreur de livraison :

1. Type de machine.
2. Numéro de série.
3. Quantité désirée de pièce de rechange. (Quantity)
4. Numéro de la pièce de rechange. (Part N°)
5. Description de la pièce de rechange. (Description)
6. Longueur en cas de commande par mètre.

SPARE PARTS

Note : To place spare parts order, use :

- The serial number of the machine
- The description and part number;

RL6070									
Ref	Designation	P/N	Qty		Ref	Designation	P/N	Qty	
			LH	HH				L	H
1	Handle complete	W272040	1	1	61	Upper seal	W274065	1	1
2	Data plate (CE)	W743583	1	1	62	Holder	W274052	2	2
	Data plate (CSA)	W743612	1	1	63	Distance ring	W274047	1	1
3	Rivet	W65430	4	4	64	O-ring	W65108	2	2
4	Nut	W84210	12	12	65	Bearing	W274048	2	2
5	Contacteur cover	W272036	1	1	66	Bearing bracket	W273033	1	1
	Contacteur cover for over current relay	W272035	1	1	67	Washer	274156	7	7
	Contacteur cover for NVB	W272196	1	1	68	Screw	W75694	7	7
6	O-ring	W65164	1	1	69	Lower seal	W274064	1	1
7	O-ring	W65130	1	1	70	Seal clamp	W274231	1	1
8	Fitting	W294127	2	2	71	Oil bag incl. pos 70	W273043	1	1
9	Cable inlet 380-500V	W254408	2	2	72	Ring for oil bag	W272028	1	1
10	Nut	W84212	2	2	73	Impeller 50Hz	W272031	1	-
11	Screw	W78698	1	1		Impeller 60Hz	W272134	1	-
12	Thrust collar	W294126	2	2	74	Impeller 50Hz	W272032	-	1
13	Washer	W51180	2	2		Impeller 60Hz	W272135	-	1
14	Stud bolt	W69640	2	2	75	Protective housing	W274107	1	1
15	Top bracket for 4x4mm ² cable	W271013	1	1	76	Outer casing	W271012	1	1
	Top bracket for 4x10mm ² cable	W273146	1	1	77	Diffusor low pressure	W271016	1	-
16	O-ring	W274062	1	1	78	Diffusor high pressure	W271018	-	1
17	O-ring	W65131	2	2	79	O-ring	W254085	1	1
18	Stud bolt	W274055	2	2	80	Diffusor holder	W271020	1	1
19	O-ring	W65141	1	1	81	Washer	W51176	4	4
20	Inner casing	W724016	1	1	82	Stud bolt	W69636	4	4
21	Stud bolt	W273035	4	4	83	Washer	W51171	16	16
22	Stator See page 12	-	-	-	84	Trim washer	W214194	28	28
23	Discharge 4" for hose	W203564	1	1	85	Diffusor centre (low pressure)	W271024	1	-
	Discharge 4" BSP thread	W203482	1	1	86	Diffusor centre (high pressure)	W271026	-	1
	Discharge 4" NPT thread	W203572	1	1	87	Strainer	W272029	1	1
24	Washer	W51170	6	6	88	Base plate	W271015	1	1
25	Stud bolt	W69640	6	6	89	Screw	W76326	6	6
26	Discharge packing	W743466	1	1	90	Spring washer	W58963	10	10
27	Jointing bracket Incl pos 4,25,28	W282059	1	1	91	Terminal block	W209928	1	1
28	Discharge packing	W284058	1	1	92	Bracket	W273068	1	1
30	Discharge 6" for hose	W283166	1	1	93	Wiring diagram	W740048	1	1
	Discharge 6" BSP thread	W283176	1	1	94	Wiring diagram NVB	W209865	1	-
	Discharge 6" NPT thread	W283168	1	1	95	Over current relay	W743523	1	1
31	El cable 4x4mm ² 20m ≥ 380V	W209558	1	1	96	Wiring diagram Δ delayed	W740045	1	1
	El cable 4x10mm ² 20m <380V	W284107	1	1	97	Wiring diagram Δ	W740046	1	1
32	Circlip	W50521	1	1	98	Bracket for time relay	W214871	1	1
33	Bearing	W61004	1	1	99	Time relay	W743509	1	1
34	Rotor	W724011	1	1	100	Over current relay	W743485	1	1
35	Cable inlet cpl ≥ 380V Incl. pos 38,39,40,41,42,43 .	W209563	1	1	101	Contacteur See page 12	-	-	-

RL6070 (continued)

Ref	Designation	P/N	Qty		Ref	Designation	P/N	Qty	
			LH	HH				L	H
36	Cable inlet cpl Incl. pos 38,39,40,41,42,43 .	W284103	1	1	102	Coil See page 12	-	-	-
37	Cable sleeve 4x4mm ²	W209560	1	1	103	Y/D start complete 380-415V	W272114	1	1
	Cable sleeve 4x10mm ²	W284110	1	1	104	Time relay	W209783	1	1
44	O-ring	W65136	2	2	105	Electrode cpl.	W208106	1	-
45	O-ring	W65006	2	2	106	Washer	W209673	2	-
46	Seal unit cpl.	W272041	1	1	107	Nut	W84205	4	-
47	Oil plug	W254042	2	2	108	Flat pin	W50331	2	-
48	Screw	W75695	4	4	109	Bracket	W294194	1	-
49	Wear plate	W271021	1	1	110	Short circuit	W209674	1	-
50	Nut	W84211	8	4	111	Electronic unit NVB 400V 50Hz	W209805	1	-
51	Distance nut	W274409	-	4		Electronic unit NVB 440V 60Hz	W367186	1	-
52	Distance sleeve	W274106	1	1		Electronic unit NVB 220V 50Hz	W367192	1	-
53	Trim washer	W274109	12	12		Electronic unit NVB 240V 60Hz	W367193	1	-
54	Support washer	W274108	1	1		Electronic unit NVB 500V	W209930	1	-
55	Lock nut	W274110	2	2	112	Terminal block 500V	W274221	1	1
56	O-ring	W274062	1	1	113	Push button cpl.	W209648	1	1
57	Bearing bracket	W271014	1	1	114	Oil 3,8 l	W367281	1	1
58	O-ring	W274086	2	2	115	Contacteur housing	W743522	1	1
59	Circlip	W50671	3	3		Coil	W209102	1	1
60	Seal holder	W274050	1	1	116	Contacteur housing	W743521	2	2
						Coil	W209102	2	2

STATOR and CONTACTOR Part Numbers

Power supply	Stator	Contacteur complete	Coil for contacteur	Stator Unit (20 + 22)
380-415V - 3 - 50Hz	W724013	W743421	W743415	W743482
440V - 3 - 60Hz	W724013	W743421	W743415	W743482
230V - 3 - 50Hz	W724013	W208128	W209775	W743482
500V - 3 - 50Hz	W724017	W743422	W743416	W743483

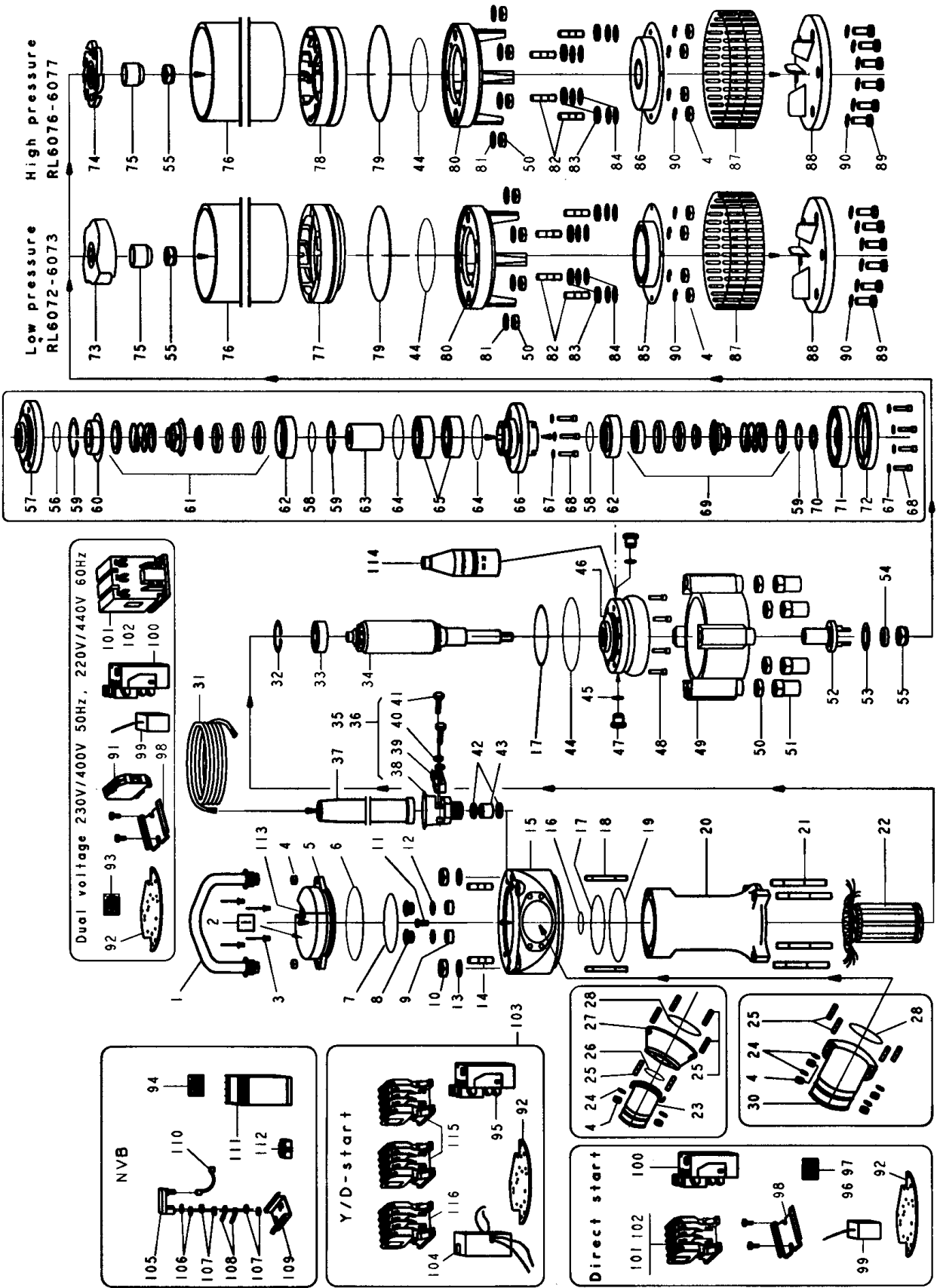

WEDA PUMP

World leader in professional submersible drainage pumps

page left intentionally blank for your convenience.



Delta Pompen B.V.

P.O. Box 310
7570 AH OLdenzaal
The Netherlands

Tel. : +31 (0)541 571667

Fax.: +31 (0)84 2242375

E-mail: info@wedapump.com

Internet: <http://www.wedapump.com>

Lübeckstraat 12
7575 EE OLdenzaal

SERVICE AND GUARANTEE.

WEDAPUMP.COM is represented worldwide by a well-established service organization. Contact your local WEDAPUMP sales office if you require more information about servicing. Or left mentioned address.

wedapump.com reserves the right to change specifications without notice