

WEDA PUMP

World leader in professional submersible drainage pumps

SPAREPARTS CATALOGUE

RL 6090



SPARE PARTS CATALOGUE

RESERVDDELSTÄLLNING

Följande uppgifter ska lämnas vid beställning av reservdelar för att undvika leveransfel :

1. Maskintyp.
2. Vältens serinummer.
3. Antal av önskad reservdel.
4. Reserdelens artikelnummer.
5. Reservedelens benämning.
6. Måttuppgifter vid beställning av metervara.

ERSATZTEILBESTELLUNG

Zur Vermeidung von Fehllieferungen sind bei der Bestellung von Ersatzteilen folgende Angaben zu machen :

1. Mashinentyp.
2. Herstellungsnummer.
3. Bestellmenge. (Quantity)
4. Ersatzteilbenennung. (Part N°)
5. Ersatzteilbenennung. (Description)
6. Massangaben bei Bestellung von Meterware.

PEDIDO DE RECAMBIOS

Para evitar errores en las entregas, deberá indicarse los siguientes datos al hacer un pedido de recambios :

1. Tipo de máquina.
2. Número de serie.
3. Cantidad de piezas deseadas. (Quantity)
4. Número de artículo de la pieza de recambio. (Part N°)
5. Denominación de la pieza. (Description)
6. Indíquese la medida al solicitar un artículo que se expide por metros.

RESERVEDELEN BESTELLEN

Om foutieve leveringen te voorkomen, vermeld bij uw bestelling de volgende informatie:

1. Type van de machine (pomp)
2. Machine serienummer
3. Aantal benodigd
4. Onderdeel nummer(s)
5. Onderdeel omschrijving
6. Afmetingen indien per lengte besteld wordt.

ORDERING SPARE PARTS

To avoid errors in delivery, please give the following information when ordering spare parts :

1. Type of machine.
2. Machine serial number.
3. Quantity required.
4. Part number.
5. Parts description.
6. Dimensions when ordering per length.

ORDINI DI RICAMBI

Per evitare errori nelle consegne di ricambi, Vi preghiamo di comunicarci le seguenti informazioni al momento dell'ordinazione :

1. Tipo di macchina.
2. Numero di serie della macchina.
3. Quantità dei pezzi desiderati. (Quantity)
4. Numero di codice del pezzo. (Part N°)
5. Descrizione del pezzo di ricambio. (Description)
6. Misura, in caso di ordine per metro.

COMMANDE DE PIÈCES DE RECHANGE

Les indications suivantes doivent être fournies lors de la commande de pièces de rechange, afin d'éviter toute erreur de livraison :

1. Type de machine.
2. Numéro de série.
3. Quantité désirée de pièce de rechange. (Quantity)
4. Numéro de la pièce de rechange. (Part N°)
5. Description de la pièce de rechange. (Description)
6. Longueur en cas de commande par mètre.

SPARE PARTS

Note : To place spare parts order, use :

- The serial number of the machine
- The description and part number;

| RL6090 | | | | | | | | | |
|--------|--|---------|-----|----|-----|----------------------------|---------|-----|----|
| Ref | Designation | P/N | Qty | | Ref | Designation | P/N | Qty | |
| | | | LH | HH | | | | LH | HH |
| 1 | Handle complete | W292062 | 1 | 1 | 60 | Stop washer | W294038 | 1 | 1 |
| 2 | Rivet | W65430 | 4 | 4 | 61 | Nut | W294037 | 1 | 1 |
| 3 | Data plate | W743583 | 1 | 1 | 62 | Bearing bracket | W291021 | 1 | 1 |
| 4 | Sealing | W209428 | 1 | 1 | 63 | O-ring | W65031 | 1 | 1 |
| 5 | Washer | W209731 | 1 | 1 | 64 | Circlip | W50679 | 3 | 3 |
| 6 | Sealing | W209429 | 1 | 1 | 65 | Seal holder | W294109 | 1 | 1 |
| 7 | Piston direct start | W209647 | 1 | 1 | 66 | Upper seal | W294107 | 1 | 1 |
| | Piston Y/D start | W274084 | 1 | 1 | 67 | Holder * | W294106 | 1 | 1 |
| 8 | Spring | W209434 | 1 | 1 | | Holder ** | W743506 | 1 | 1 |
| 9 | Guide | W209435 | 1 | 1 | 68 | O-ring | W294105 | 2 | 2 |
| 10 | Nut | W84211 | 6 | 6 | 69 | Distance ring * | W294112 | 1 | 1 |
| 11 | Cover 380-500V | W292064 | 1 | 1 | | Distance ring ** | W743531 | 1 | 1 |
| | Cover for NVB | W292213 | 1 | 1 | 70 | O-ring | W65112 | 2 | 2 |
| 12 | Nut | W84210 | 7 | 7 | 71 | Bearing | W294111 | 2 | 2 |
| 13 | Washer | W209438 | 1 | 1 | | Bearing cpl Incl pos 69,71 | W294110 | 1 | 1 |
| 14 | Screw | W209501 | 1 | 1 | 72 | Bearing bracket | W292055 | 1 | 1 |
| 15 | O-ring | W65134 | 3 | 3 | 73 | Washer | W294171 | 7 | 7 |
| 16 | O-ring | W65251 | 1 | 1 | 74 | Lower seal | W294108 | 1 | 1 |
| 17 | Plug | W294127 | 2 | 2 | 75 | Oil bag Incl. pos 76 | W293088 | 1 | 1 |
| 18 | Sleeve 380-500V | W294164 | 2 | 2 | 76 | Seal clamp | W294226 | 1 | 1 |
| | Sleeve 220V Y/D | W294125 | 2 | 2 | 77 | Ring for oil bag | W294103 | 1 | 1 |
| 19 | Screw | W78698 | 1 | 1 | 79 | Impeller 50Hz | W292043 | 1 | - |
| 20 | Thrust collar | W294126 | 2 | 2 | | Impeller 60Hz | W292044 | 1 | - |
| 21 | Nut | W84213 | 2 | 2 | 80 | Washer | W294036 | 1 | 1 |
| 22 | Stud bolt | W69656 | 6 | 2 | 81 | Impeller nut | W294035 | 1 | 1 |
| 23 | Top bracket 380-415V Y/D direct start | W291020 | 1 | 1 | 82 | Protective housing | W292065 | 1 | 1 |
| | Top bracket 380-415VY/D start | W292204 | 1 | 1 | 83 | Diffusor | W291012 | 1 | - |
| | Top bracket 230V for external protection | W292312 | 1 | 1 | 84 | O-ring | W65174 | 1 | 1 |
| | Top bracket 230V | W293097 | 1 | 1 | 85 | O-ring | W65137 | 1 | 1 |
| | Top bracket 380-415V external Y/D start without thermal protection | W730011 | 1 | 1 | 86 | Diffusor holder | W293080 | 1 | 1 |
| 24 | O-ring | W65033 | 1 | 1 | 87 | Washer | W51181 | 6 | 6 |
| 25 | O-ring | W65177 | 2 | 2 | 89 | Washer | W51176 | 8 | 8 |
| 26 | Stud bolt | W294123 | 2 | 2 | | Trim washer | W294124 | 20 | 20 |
| 27 | O-ring | W65143 | 1 | 1 | 90 | Diffusor centre | W291014 | 1 | - |
| 28 | Inner casing | W291025 | 1 | 1 | 91 | Spring washer | W58915 | 10 | 10 |
| 29 | Stud bolt | W293087 | 4 | 4 | 92 | Strainer | W294102 | 1 | 1 |
| 30 | Stator See page 12 | - | - | - | 93 | Base plate | W293091 | 1 | 1 |
| 31 | Discharge 4" for hose | W203564 | 1 | 1 | 94 | Screw | W76343 | 6 | 6 |
| | Discharge 4" BSP thread | W203482 | 1 | 1 | 95 | Impeller 50 Hz | W292045 | - | 1 |
| | Discharge 4" NPT thread | W203572 | 1 | 1 | | Impeller 60Hz | W292046 | - | 1 |
| 32 | Washer | W51170 | 6 | 6 | 96 | Diffusor | W291016 | - | 1 |
| 33 | Stud bolt | W69640 | 6 | 6 | 97 | Spacer | W294191 | - | 4 |
| 34 | O-ring | W743466 | 1 | 1 | 98 | Stud bolt | W69656 | - | 4 |
| 35 | Jointing bracket Incl pos 12,32,33,36. | W282059 | 1 | 1 | 99 | Diffusor centre | W291018 | - | 1 |

RL6090 (continued)

| Ref | Designation | P/N | Qty | | Ref | Designation | P/N | Qty | |
|-----|---|---------|-----|----|-----|---|---------|-----|----|
| | | | LH | HH | | | | LH | HH |
| 36 | Discharge packing | W284058 | 1 | 1 | 100 | Electrode | W208106 | 1 | - |
| 37 | Discharge 6" for hose | W283166 | 1 | 1 | 101 | Washer | W209673 | 2 | - |
| | Discharge 6" BSP thread | W283176 | 1 | 1 | 102 | Nut | W84205 | 4 | - |
| | Discharge 6" NPT thread | W283168 | 1 | 1 | 103 | Flat pin | W50331 | 2 | - |
| 38 | Cable inlet cpl .4x10mm ² 415-550V Y/D start incl. pos 44,49 . | W284103 | 1 | 1 | 104 | Bracket | W209672 | 1 | - |
| | Cable inlet cpl .4x16mm ² 400V incl. pos 44,49 . | W284104 | 1 | 1 | 105 | Wiring diagram | W209865 | 1 | - |
| | Cable inlet cpl .4x25mm ² 230V incl. pos 44,49 . | W209580 | 1 | 1 | 106 | Short circuit | W209674 | 1 | - |
| 39 | Cable 4x10mm ² 415-550V direct start | W283105 | 1 | 1 | 107 | Electronic unit NVB 400V 50Hz | W209805 | 1 | - |
| | Cable 4x10mm ² 400V Y/Dstart 415V Y/D start | W283105 | 2 | 2 | | Electronic unit NVB 440V 60Hz | W367186 | 1 | - |
| | Cable 4x16mm ² 400V direct start | W284108 | 1 | 1 | | Electronic unit NVB 220V 50Hz | W367192 | 1 | - |
| | Cable 4x16mm ² 400V Y/D start | W284108 | 1 | 1 | | Electronic unit NVB 240V 60Hz | W367193 | 1 | - |
| | Cable 4x25mm ² 230V+230/400V | W208093 | 1 | 1 | | Electronic unit NVB 500V 50Hz | W209930 | 1 | 1 |
| 40 | Circlip | W50525 | 1 | 1 | 108 | Time relay 220-500V | W743509 | 1 | 1 |
| 41 | Bearing | W61003 | 1 | 1 | 109 | Terminal block 25mm ² | W209874 | 1 | 1 |
| 42 | Cable sleeve 4x10mm ² | W284110 | 1 | 1 | 110 | Time relay Y9a 400V | W209783 | 1 | 1 |
| | Cable sleeve 4x16mm ² | W284100 | 1 | 1 | 111 | Y/D Start cpl 400V | W292069 | 1 | 1 |
| | Cable sleeve 4x25mm ² | W743583 | 1 | 1 | 113 | Over current relay | W299593 | 1 | 1 |
| 43 | Rotor | W292053 | 1 | 1 | 114 | Bracket | W292061 | 1 | 1 |
| 50 | O-ring | W65140 | 1 | 1 | 115 | Contactora See page 12 | - | - | - |
| 51 | O-ring | W65006 | 2 | 2 | 116 | Coil See page 12 | - | - | - |
| 52 | Seal unit cpl | W292054 | 1 | 1 | 117 | Over current relay 220/440V60Hz | W294155 | 1 | 1 |
| 53 | Oil plug | W274084 | 2 | 2 | | Over current relay 500V 50Hz | W743517 | 1 | 1 |
| 54 | Screw | W75711 | 11 | 11 | | Over current relay 230/400V 50Hz 440/500V60Hz | W743549 | 1 | 1 |
| 55 | Wear plate | W291010 | 1 | 1 | 118 | Short circuit | W209928 | 1 | 1 |
| 56 | Nut | W84213 | 8 | 8 | 119 | Bracket | W214871 | 1 | 1 |
| 57 | Distance sleeve | W294041 | 1 | 1 | 120 | Wiring diagram | W740049 | 1 | 1 |
| 58 | Connection | W294039 | 1 | 1 | | Wiring diagram | W740276 | 1 | 1 |
| 59 | Trim washer | W294040 | 10 | 10 | | Wiring diagram | W740277 | 1 | 1 |
| | | | | | 122 | Oil 5,2 l | W60015 | 1 | 1 |

* Pumps with manufacturing N° below 1971 . ** Pumps with manufacturing N° above 2000 .

STATOR and CONTACTOR Part Numbers

| Power supply | Stator | Contactora complete | Coil for contactora | Stator Unit (28 + 30) |
|---------------------|---------|---------------------|---------------------|-----------------------|
| 380-400V - 3 - 50Hz | W294139 | W208125 | W209771 | W294149 |
| 415V - 3 - 50Hz | W294140 | W208126 | W209772 | W294169 |
| 440V - 3 - 60Hz | W294139 | W208125 | W209771 | W294149 |
| 500V - 3 - 50Hz | W294154 | W208127 | W209773 | W294170 |

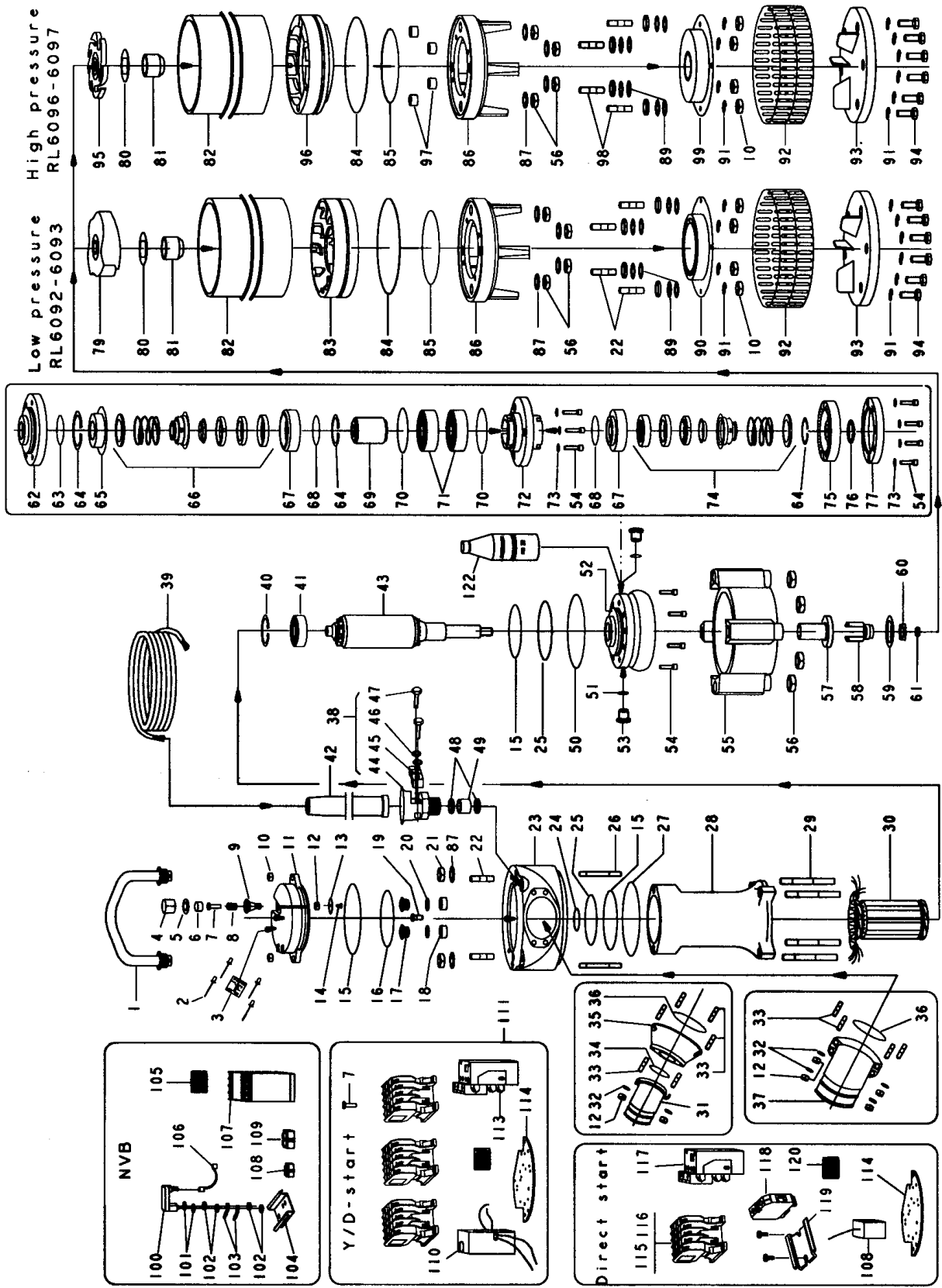

WEDA PUMP

World leader in professional submersible drainage pumps

page left intentionally blank for your convenience.



Delta Pompen B.V.

Rigaweg 17
9723 TE Groningen
The Netherlands
Tel.: +31 (0)50-2072380

E-mail: info@deltapompen.com
Internet: <http://www.wedapump.com>

SERVICE AND GUARANTEE.

WEDAPUMP.COM is represented worldwide by a well-established service organization. Contact your local WEDAPUMP sales office if you require more information about servicing. Or left mentioned address.

wedapump.com reserves the right to change specifications without notice